



THE **FUTURE** OF
EXPERIENCE SHOPPING

Cyber**Vibe**2

SECTOR 140 A, NOIDA EXPRESSWAY

CyberVibe 2

SECTOR 140 A, NOIDA EXPRESSWAY
GET THE BEST OF SPORTS EQUIPMENT AND ELECTRONICS

AT



PROPOSED FUTURE
TOWER



THE *Retail* HUB

If Cyberthum is the lifeforce for the millennials, where they live, work and thrive, the upper ground floor is the pulse. It is where discussions move from boardrooms to coffee tables, networking happens over casual dinners, and formal celebrations turn into exhilarating parties. It is where millennials meet, dine, shop and most of all, connect.



WALKWAYS



SEATING AREAS

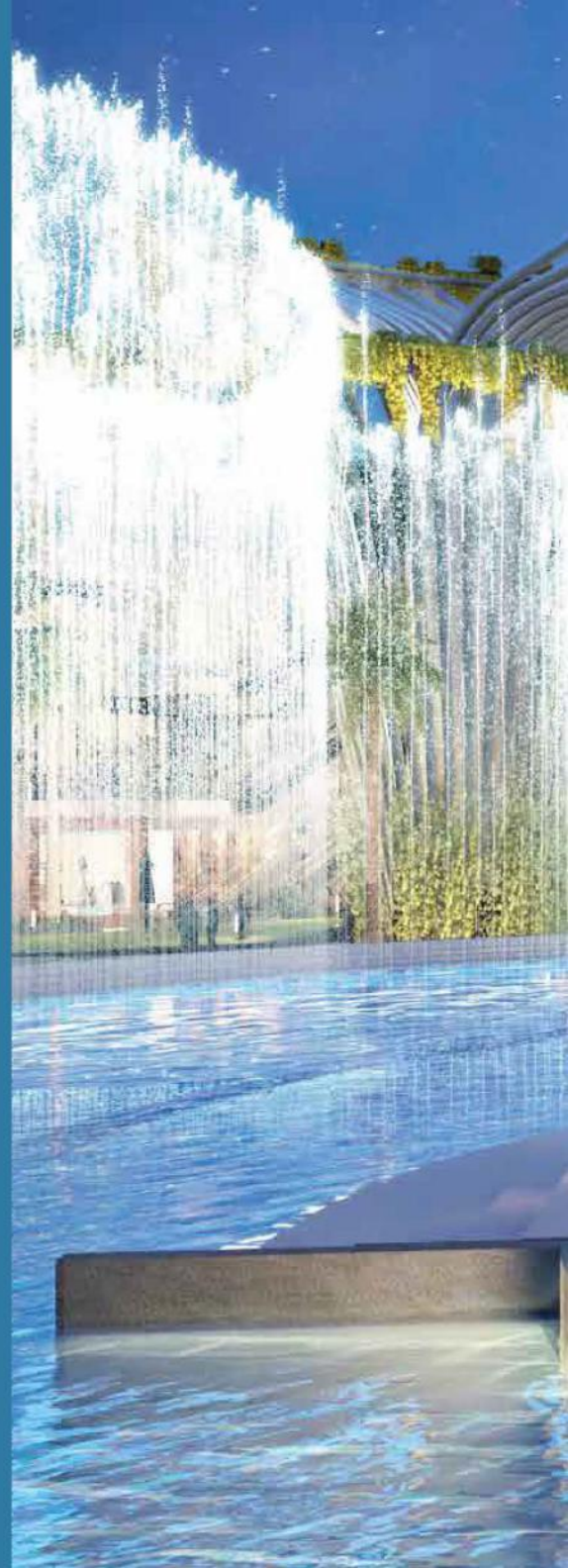



MUSICAL FOUNTAIN

Putting UP THE BEST FRONT

When top-notch companies, multinationals and professionals come together at the same place, world-class brands get a ready platform to showcase their best products and services. The frontage at Cyberthum gives the most premium brands the exclusive space they deserve. Customise your space to suit your design sensibilities, or simply plug, play and prosper.

- Frontage to host the world's best brands
- Offering high visibility
- Spaces for over 100 or more brands
- Conventional retail shops



SEATING AREA



CAFE AREA



SEATING & DECK



SHOPPING STREET



SEATING AND DECK

TAKE THE *High Street* TO GROWTH

Part of the 26.8 acre mixed use development, and covering Lakhs of sq. ft. of area, these spaces cater to the entire population at Cyberthum as well as visitors. No wonder, why it holds a center place in the complex.



WATER SIDE DINING



GRASS JOINTED PAVING



AMPHI-THEATRE

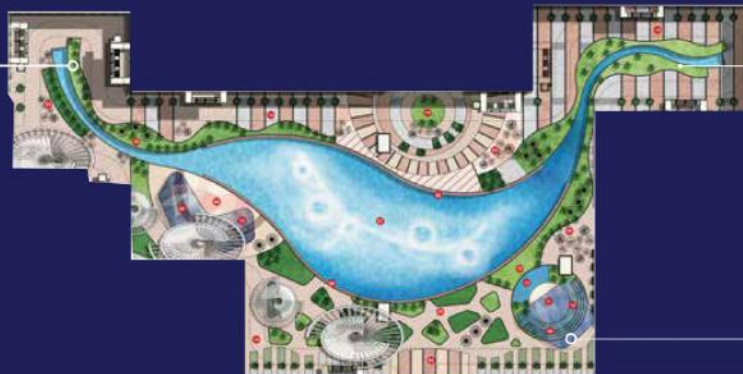



VAN HUIJSEN

BLACKBERRY

ADIDAS

SUPREME

KALIN

HUGO BOSS

PEPE

Designed TO BE NOTICED

The retail spaces are designed to do what any business looks for - gaining maximum visibility. From efficient floor plans for easy mobility to shops designed along the fountain or open spaces for easy access, they ensure that there is no obstruction between your customer and your outlet.

- Entirely pedestrianised plazas
- Dedicated branding signage for every outlet
- Fountain facing and road facing shops to ensure clear visibility





SHOE MERT

DellY BaZ

Sedivy

FENGUSOM

GUESE

AMPERE

BOOSE

KK KohnKohn

ROAD FACING SHOPS

FOR THE **DELIGHT** BEFORE YOU BUY IT

Shopping isn't about just buying a product. It's about the experience. It's to indulge all your senses - to see and be captured by the variety of products, to touch, feel and experience the products and to make the final decision, of what goes in your shopping bag. This experience is something all the online stores in the world can't match. The sheer joy of shopping. Cybervibe - 2 brings you the finest shopping experience in something people love to experience first - sports equipment and electronics & gadgets.





FOR THE **EXPERIENCE** THAT'S SHOPPING

Cybervibe - 2 presents large format specialist retail spaces that cater to multi-brand sports equipment and digital gadgets & home electronics needs. Focused on creating an enhanced experience, these stores will have the largest variety of products to choose from and enough space to make it an experience. Customers' will be able to try different products, play with them, get all the details they need instantly and get a wholesome experience before they decide to buy it.





THE PLAY ARENA FOR SPORTS ENTHUSIASTS

Cybervibe - 2 steps up the game when it comes to sports equipment. By bringing multiple top brands on one platform, it creates a great selection of products for customers to choose from - the lightest, the sturdiest, the finest products, for beginners and for professionals; from the most reasonably priced to high-end products. It puts all the power in the customers' hands - the power of choice.





THE A TO Z OF *sports*

Get ready to be amazed with the largest variety of sports equipment for everything you can imagine - from casual running shoes to trekking and hiking gear, yoga mats to cycling equipment, tennis racquets to billiards table, ask for it and you'll find it. With experts to advise you on the best product for your needs and to demonstrate the right way to use them, you can be sure to be satisfied with your shopping experience.



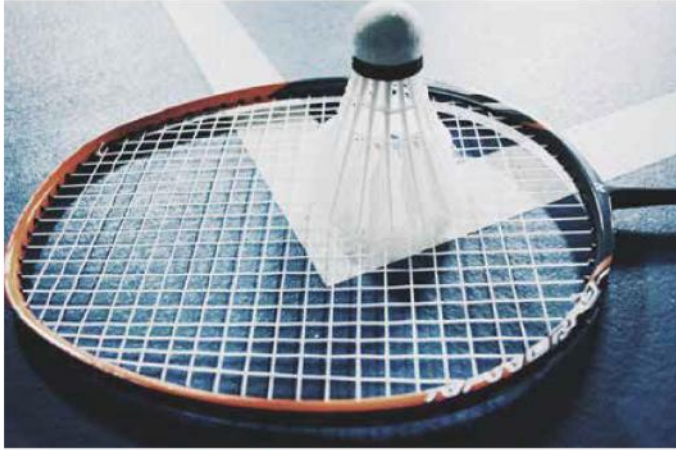

THE PLAY ARENA FOR *Tech* ENTHUSIASTS

Even the most tech-friendly person would never be happy just looking at the specifications. Cybervibe - 2 caters to the digital savvy and gadget-loving customers by giving them a hands on experience of what they love the most. Imagine a store presenting a range of the most innovative and unique tech products and turning it into a playground for tech enthusiasts - with interactive experience zones, the widest range of products and tech experts to help enrich their experience further.





THE A TO Z OF *Electronics*

Walk into a world of electronics with the most cutting edge products for all your needs, from beautifully designed home appliances to the latest mobile phones, tablets and laptops. Experience superb visuals and sounds at an experience center that lets you try the finest TVs, the coolest sound systems, gaming consoles and more. And if all that confuses you, you can always let tech experts guide you on the best fit for your needs.





EXPERIENCE *Growth* FASTER THAN EVER

As a part of one of the busiest commercial and retail centers, Cybervibe - 2 is ready to set new benchmarks as the one-of-its-kind shopping destination in Noida, meeting the extensive needs of sports equipment and electronics shoppers in India.

Not only that, it presents an unprecedented opportunity for investment, with limitless opportunities in the future. If you see your business here, now is the time to get there.





A VIEW OF RETAIL ARENA

DELIVERED PROJECTS



Offering one of the largest infinity pools in India, Alphathum lays the ground for efficient and smart office spaces.



Arrive at an exclusive address. It's Noida's leading retail destination. Enter a space that's designed around your needs and enhanced by excellent hospitality services. Leave your worries at the door, this is your space where your priorities are respected.



Techno Park, Tower - B is one of the commercial development, located in Noida. It offers spacious and skillfully designed office space on 4th & 5th Floor. The project is well equipped with all the amenities to facilitate the needs of the office people.

PARMESH COMPLEX, Nirman Vihar

PARMESH CORPORATE TOWER, Karkardooma

PARMESH COMPLEX I, Karkardooma

PARMESH COMPLEX II, Karkardooma

PARMESH BUSINESS CENTRE I: Karkardooma

PARMESH BUSINESS CENTRE II, Karkardooma

IIT ENGINEERS CO-OPERATIVE GROUP

HOUSING SOCIETY, Dwarka

WORLD SQUARE MALL, Ghaziabad



The future of IT parks !

The I-THUM is a landmark development and the future of IT Parks in Noida, Sector 62. It offers Commercial Office Spaces and also shares the campus of the Corenthum including some leading banks.



WORLD SQUARE
MALL

World Square Mall, by Bhutani Group is one of the leading malls in ghaziabad with a multiplex, banquet, and a 3 Star Hotel, as its part.



WORLD
SQUARE
HOTEL

World Square Hotel is a 3-star property in Ghaziabad that provides a comfortable stay and unmatched hospitality along with the easy access to the entertainment, shopping, and business hubs of the region.



ON GOING PROJECTS



Part of a 26.8 Acre mixed-use development, Cyberthum is NCR's tallest commercial tower with world-class spaces, mall in the sky, and Bolt, one of India's biggest gaming and entertainment centers.



City Centre 150 is a glimpse into the future of retail and lifestyle entertainment. With al-fresco style high-street retail in a low-rise development, the project is built to immerse visitors in a world of seamless convenience.



Bhutani 18 is a part of a meticulously planned integrated township sprawling over 463.60 ha. It brings together everything that forms a part of a great community, from residences to offices, retail, sports, entertainment, education and healthcare.





+91 9313 110 110

Site Office: Plot No. 2, Sector-140A, Marketing Office: Plot No. 1, Sector 90, Noida
Corporate Office: Plot No 3 & 4, 2nd Floor, A-Block Market, Savitri Bhawan, Preet Vihar, Delhi-92
Ph: 0120 - 490 90 90 | E: info@bhutanigroup.com | www.bhutanigroup.com

The Pictures and details are tentative depictions only. This is not a legal offer. Mentioned features are Indicative and are subject to change without any prior notice as may be decided by the company or competent authority. Terms and Conditions Apply. Special Scheme by the developer 15q Mtr = 10.764 Sq Ft & 1Sq. Yd = 0.83 Sq Mtr. Allotment Details : NOIDA/IND/2007/7702 Dated 17.12.2007. Sanction Details : NOIDA/MU.VA.NI/2018/BP-12619/590 Dated 26.12.2018. RERA No. Bhutani Group # UPRERAPR170627, CYBERTHUM PHASE A : UPRERAPR2256478, CYBERTHUM PHASE B : UPRERAPR3240015, CYBERTHUM PHASE E : UPRERAPR2190938, CYBERTHUM PHASE H : UPRERAPR3674006.